

Specifications	
Precision grade	KHK R 001 Grade 4 *
Gear teeth	Standard full depth
Pressure angle	20°
Material	S45C
Heat treatment	—
Tooth hardness	(less than HB210)
Surface treatment	Black oxide coating

* The precision grade of J Series products is equivalent to the value shown in the table.

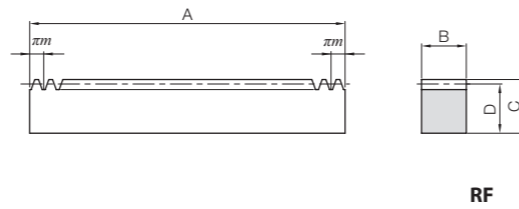

Catalog Number	Module	No. of teeth	Shape	Total Length A	Face width B	Height C	Height to pitch line D	Allowable force (N)		Allowable force (kgf)	
								Bending strength	Surface durability	Bending strength	Surface durability
SRAF1.5-1000	m1.5	212	RF	999.03	15	15	13.5	2160	421	220	42.9
SRAF2-1000	m2	160		1005.31	20	20	18	3830	775	391	79.0
SRAF2.5-1000	m2.5	128		1005.31	25	25	22.5	5990	1240	611	127
SRAF3-1000	m3	106		999.03	30	30	27	8620	1820	879	186
SRAF4-1000	m4	80		1005.31	40	40	36	15300	3330	1560	339
SRAF1.5-2000	m1.5	435		2049.88	17	17	15.5	2443	421	249	43
SRAF2-2000	m2	326		2048.31	20	20	18	3833	775	391	79
SRAF2.5-2000	m2.5	261		2049.88	25	25	22.5	5989	1241	611	127
SRAF3-2000	m3	217	2045.17	30	30	27	8624	1821	879	186	

Catalog Number	Module	No. of teeth	Shape	Total Length A	Face width B	Height C	Height to pitch line D	Mounting hole dimensions				
								E	F	G	No. of holes	Screw size
● SRAFK1.5-1000J	m1.5	212	RA	999.03	15	15	13.5	5	49.51	180	6	M5
● SRAFD2-1000J	m2	160	RD	1005.31	20	20	18	7	52.65			
● SRAFD2.5-1000J	m2.5	128	RD	1005.31	25	25	22.5	9	52.65			
● SRAFD3-1000J	m3	106	RD	999.03	30	30	27	11	49.51			
● SRAFD4-1000J	m4	80	RD	1005.31	40	40	36	15	52.65			

J Series

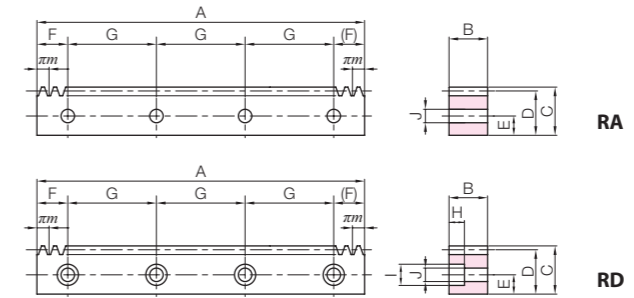

Backlash (mm)	Weight (kg)	Catalog Number
0.09~0.25	1.59	SRAF1.5-1000
0.11~0.28	2.84	SRAF2-1000
0.13~0.31	4.44	SRAF2.5-1000
0.14~0.35	6.35	SRAF3-1000
0.18~0.42	11.4	SRAF4-1000
0.09~0.25	4.24	SRAF1.5-2000
0.11~0.28	5.79	SRAF2-2000
0.13~0.31	9.05	SRAF2.5-2000
0.14~0.35	13.0	SRAF3-2000

Counterbore dimensions			Allowable force (N)		Allowable force (kgf)		Backlash (mm)	Weight (kg)	Catalog Number
H	I	J	Bending strength	Surface durability	Bending strength	Surface durability			
—	—	6	2160	421	220	42.9	0.09~0.25	1.57	● SRAFK1.5-1000J
7	11	7	3830	775	391	79.0	0.11~0.28	2.79	● SRAFD2-1000J
8.6	14	9	5990	1240	611	127	0.13~0.31	4.33	● SRAFD2.5-1000J
10.8	17.5	11	8620	1820	879	186	0.14~0.35	6.14	● SRAFD3-1000J
13	20	14	15300	3330	1560	339	0.18~0.42	11.0	● SRAFD4-1000J

Recommended Mating Pinions



SS Spur Gears

Please see Page 104 for more details.